



1



Check the panel

After measuring the wall and determining the dimensions, **put the slab horizontally** on a cutting table (polished side on top).

2



Cut to size

Use a **water-supplied cutting device** compatible with a diamond blade to cut the slabs. **Put the cutter guides on the panel**. Slowly, cut the panels into lengths.

3



Clean and apply the primer

Clean and levelled the base walls and apply the recommended **Sustainable primer**.

4

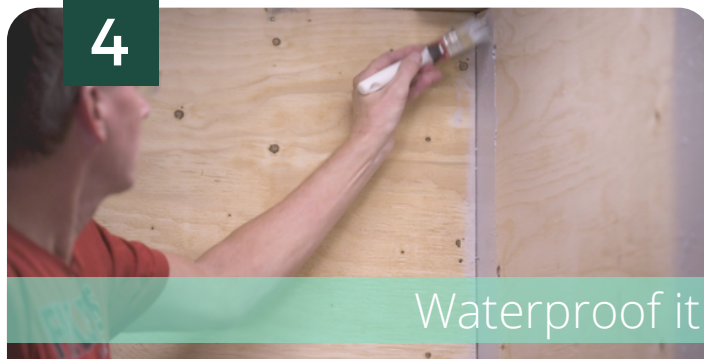

Waterproof it

Apply the 1st layer (15 cm width) of the waterproof membrane in the vertical inner corner (the connection between wall and floor and the joint between the two slabs).

5

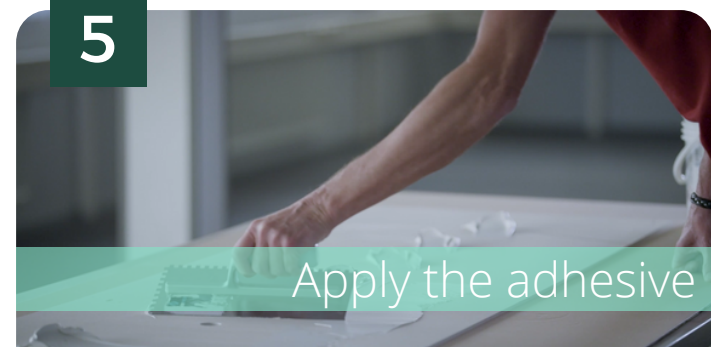

Apply the adhesive

After cleaning the surface of the slab with a damp sponge, **apply the adhesive on the back of the panel** with the flat side of the trowel in straight lines using the **Back butter method**.

Put adhesive on the wall as well with the notched side of the trowel and proceed to the placement of the panel.



Now **apply the waterproof tape** on the areas with a waterproof membrane.

Apply a 2nd layer of the waterproof membrane.

6



Place the panel

Press the panel gently onto the surface (use a pressing tool to help). When placing the panel, **ensure all the edges adhere to the surface**. If any adhesive seeps out, remove it immediately with a damp cloth.





7



Level the slabs

Level the slabs with a **levelling system** to prevent any movement of the panel during the adhesive's setting.

Add the clips behind the panel and continue installing them. **Add the wedges through the clips** when all panels are installed.

After the adhesive sets, **remove the levelling elements with a hammer**, striking the clips, always in the direction of the joint.

8



Add silicone

Add the silicon kit to the joints. Then, use a **scraper to press the kit in the joint.** Clean the panels where necessary. Let it dry and the work is done.

TOOLS NEEDED

FOR CUTTING

Cutter guides | waterspout | circular saw + kit | cordless drill |

TO ADHERE THE SLAB

Block brush | roller | Mapei primer G|Mapei Mapegum WPS | Mapei Ultrabond ECO PU 2K |Mapei waterproof tape | mixer for adhesive | pressing tool | trowel & spatula |

TO LEVEL THE SLAB

Mapei levelling system | hammer | silicone kit pistol | Mapesil LM & scraper |



RECOMMENDED ADHESIVES

SURFACES

- Elastorapid powder adhesive
- Alternative options:
 - Mapeflex MS 45 kit, with grooves at a distance of center to center 5 cm
 - Ultrabond Eco PU 2K
 - Kerapoxy (Only for Turkey market)

RECOMMENDED SAWS AND DRILLS

CUTTING & DRILLING

TYPE

Portable electric circular cutter

Rubi TC- 125 + full kit

Blades

All diamond blades except the segmented diamond blades

Drills

Diamond tipped drill bits both dry and wet